

MANUAL / ANLEITUNG

- *Assembling wooden housing for -*

- *Montage Holzgehäuse für -*

FTS2

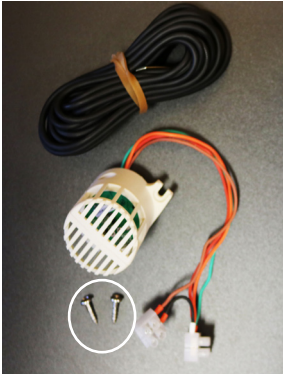

2 Stk. PH 3,5 x 17 mm

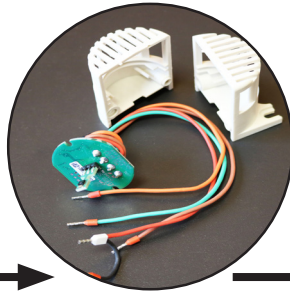

1 Stk. TX 3 x 25 mm

2 Stk. PH 3 x 13 mm

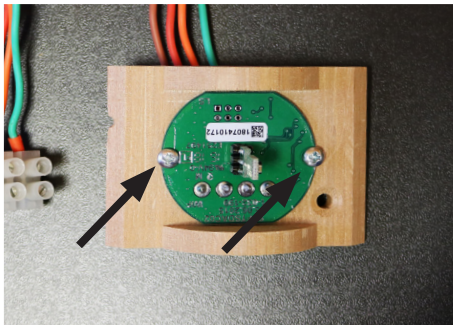

2 Stk. PH 3 x 13 mm



1 Stk. PH 3,5 x 17 mm

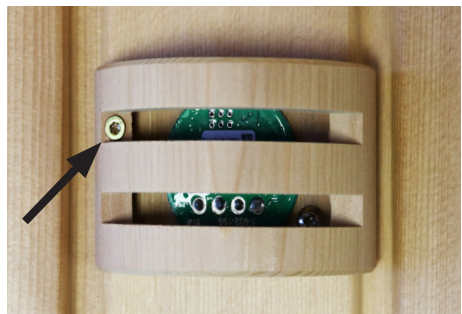

1 Stk. TX 3 x 25 mm



GLOBAL: Harvia Finland Oy | P.O. Box 12 | Teollisuustie 1-7 | 40951 Muurame | FINLAND | +358 207 464 000 | harvia@harvia.fi
CENTRAL EUROPE: Harvia Austria GmbH | Wartenburger Straße 31 | A-4840 Vöcklabruck | +43 (0) 7672/22900-50 | info@harvia.com
www.harvia.com



MANUAL / ANLEITUNG

- Assembling wooden housing for -

- Montage Holzgehäuse für -

FTS2

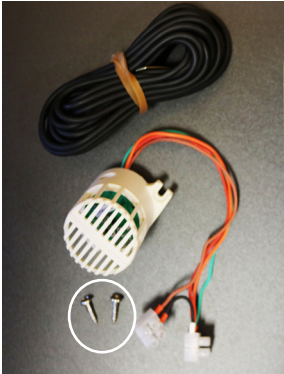

2 Stk. PH 3,5 x 17 mm

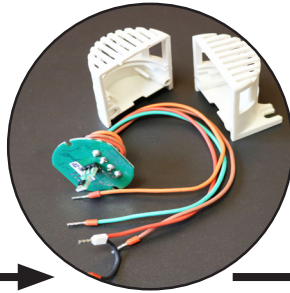

1 Stk. TX 3 x 25 mm

2 Stk. PH 3 x 13 mm

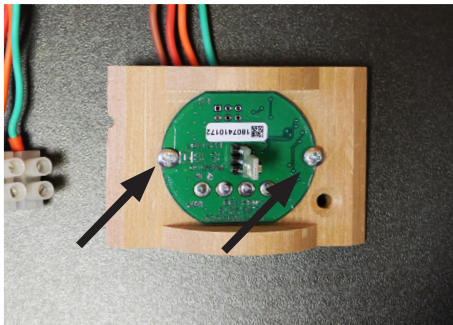

2 Stk. PH 3 x 13 mm



2 Stk. PH 3,5 x 17 mm

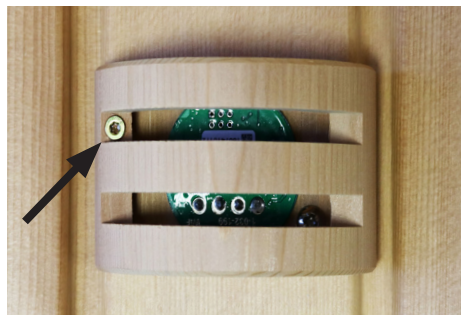

1 Stk. TX 3 x 25 mm



GLOBAL: Harvia Finland Oy | P.O. Box 12 | Teollisuustie 1-7 | 40951 Muurame | FINLAND | +358 207 464 000 | harvia@harvia.fi
CENTRAL EUROPE: Harvia Austria GmbH | Wartenburger Straße 31 | A-4840 Vöcklabruck | +43 (0) 7672/22900-50 | info@harvia.com
www.harvia.com

