

# SAUNA HEATER QUBE 240

## Sauna heater QUBE 240

■ 18 / 21 / 24 kW Art.-Nr.: QUBE-240 / 1-041-536

## Innovative technology

- Sauna heater output: 18 kW, 21 kW or 24 kW
- Internal components made from stainless steel
- Easy to service thanks to the removable connection box
- Optional:
  - Wooden railing incl. holder set already mounted (nut and lime)

## Delivery:

- Sauna heater
- Installation and use instructions



## Technical specifications:

power heater (kW)	cabin volume (m <sup>3</sup> )	weight without stones (kg)	stone quantity (kg)
18	20 - 30	59	70
21	23 - 35	59	70
24	25 - 40	59	70

Art. nr.	Power kW	Output power (kW) group I	Output power (kW) group II	Safeguarding group I	Safeguarding group II	Providing
QUBE-240	18	9	9	3 x 16	3 x 16	400 V AC 3N~ 50/60 Hz
	21	12	9	3 x 20 / 25	3 x 16	
	24	12	12	3 x 20 / 25	3 x 20 / 25	
	24	18	6	3 x 35	3 x 10	

## Dimensions (mm)

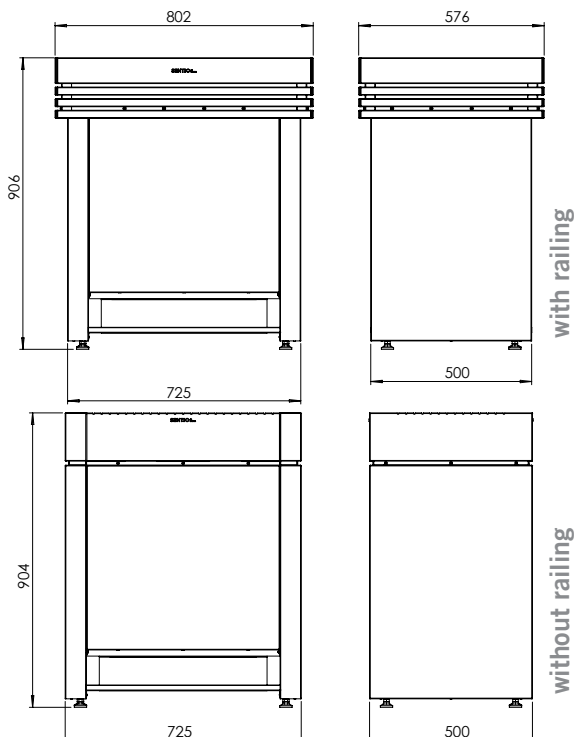

## Minimum safety distances (mm)

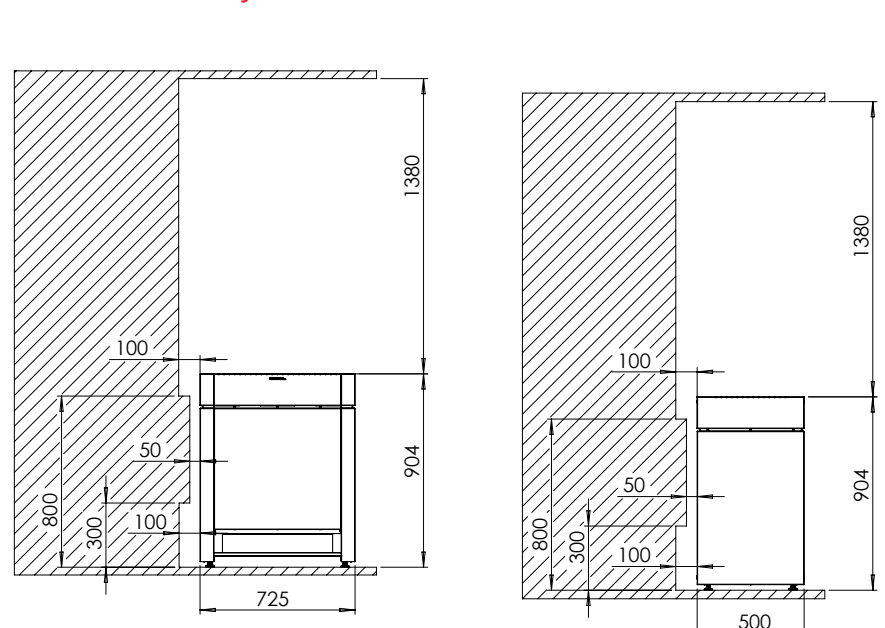

# SAUNA HEATER QUBE 240

## Electrical connections

### Qube 18 - 24 kW

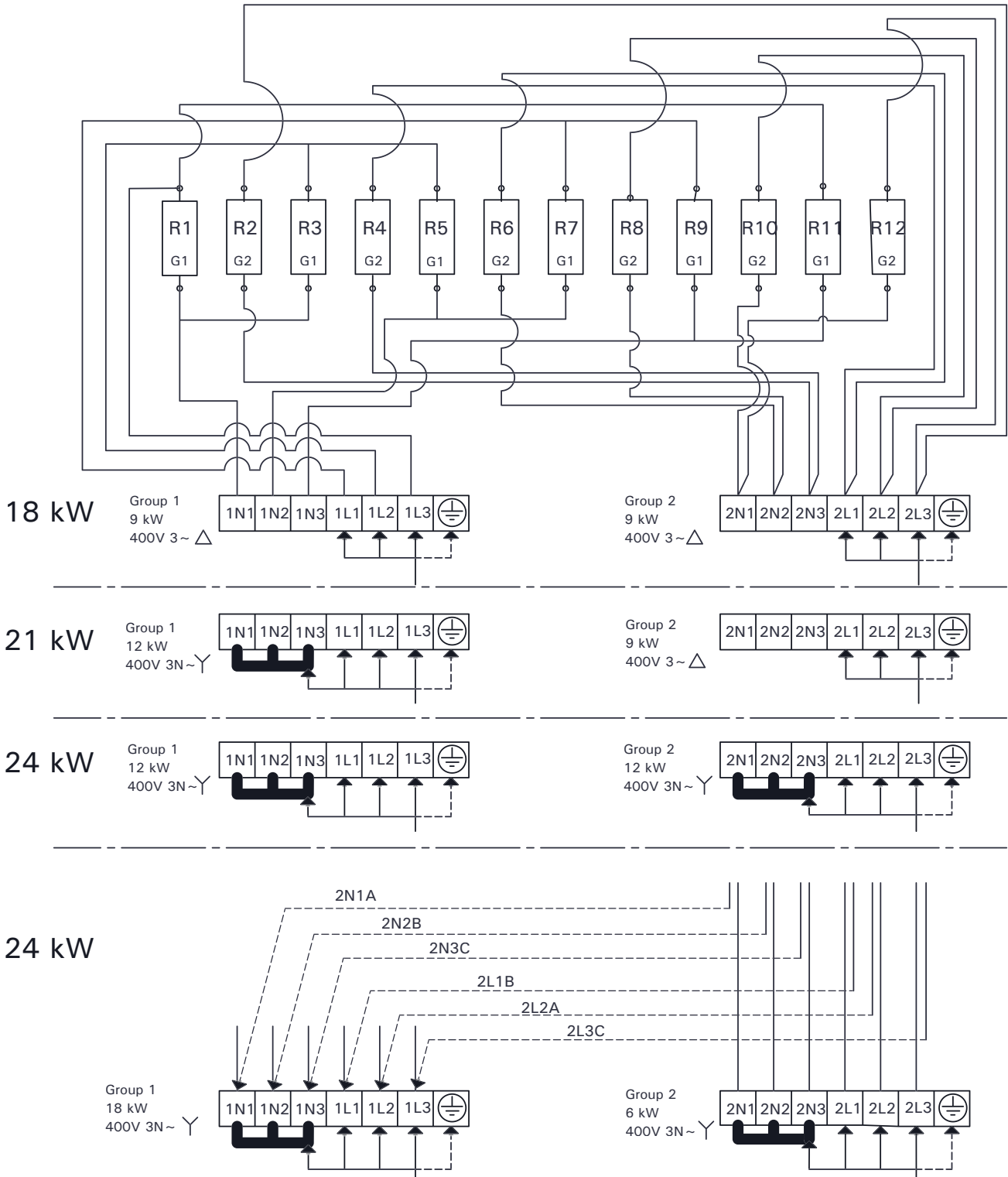

Y05-0394

# SAUNAOFEN QUBE 240

## Saunaofen Qube 240:

- 18 / 21 / 24 kW Art.-Nr.: QUBE-240 / 1-041-536

## Innovative Technologie

- Saunaofen Leistung je nach Anschlussart: 18 kW, 21 kW oder 24 kW
- Innenteile aus Edelstahl
- Servicefreundlich durch entnehmbaren Anschlusskasten
- Optional:
  - Holzreling inkl. Halterungsset vormontiert (Nuss oder Linde)

## Lieferumfang:

- Saunaofen
- Temperaturfühler (WX 255)
- Montage- und Gebrauchsanweisung



## Technische Details:

Leistung Ofen (kW)	Abmessungen B / T / H	Kabinenvolumen (m³)	Gewicht ohne Steine (kg)	Steinmenge (kg)
18	725 / 500 / 920	20 - 30	59	70
21	725 / 500 / 920	23 - 35	59	70
24	725 / 500 / 920	25 - 40	59	70

Artikelnr	angeschlossene kW	Output Leistung kW Gruppe I	Output Leistung kW Gruppe II	Sicherung Gruppe I	Sicherung Gruppe II	Versorgung
QUBE-240	18	9	9	3 x 16	3 x 16	400 V AC 3N~ 50/60 Hz
	21	12	9	3 x 20 / 25	3 x 16	
	24	12	12	3 x 20 / 25	3 x 20 / 25	
	24	18	6	3 x 35	3 x 10	

## Abmessungen (mm)

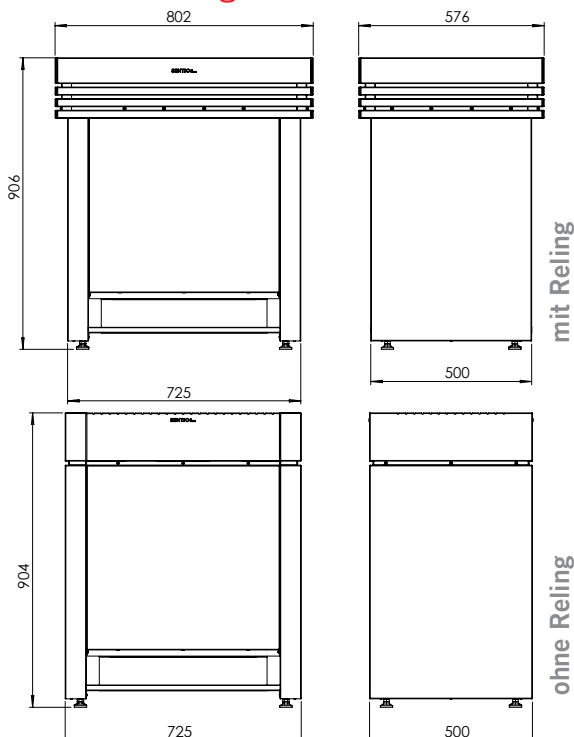

## Mindestabstände (mm)

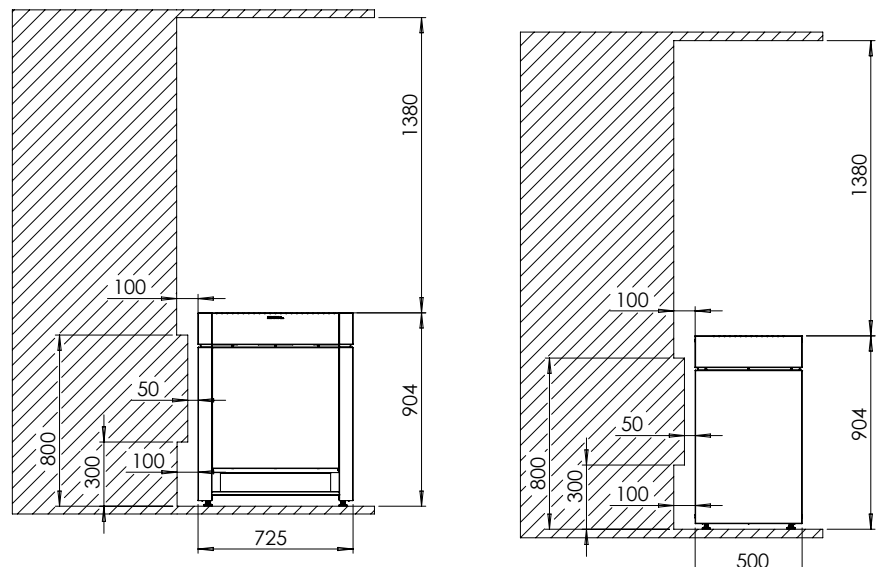

# SAUNAOFEN QUBE 240

## Anschlussmöglichkeiten:

### Qube 18 - 24 kW

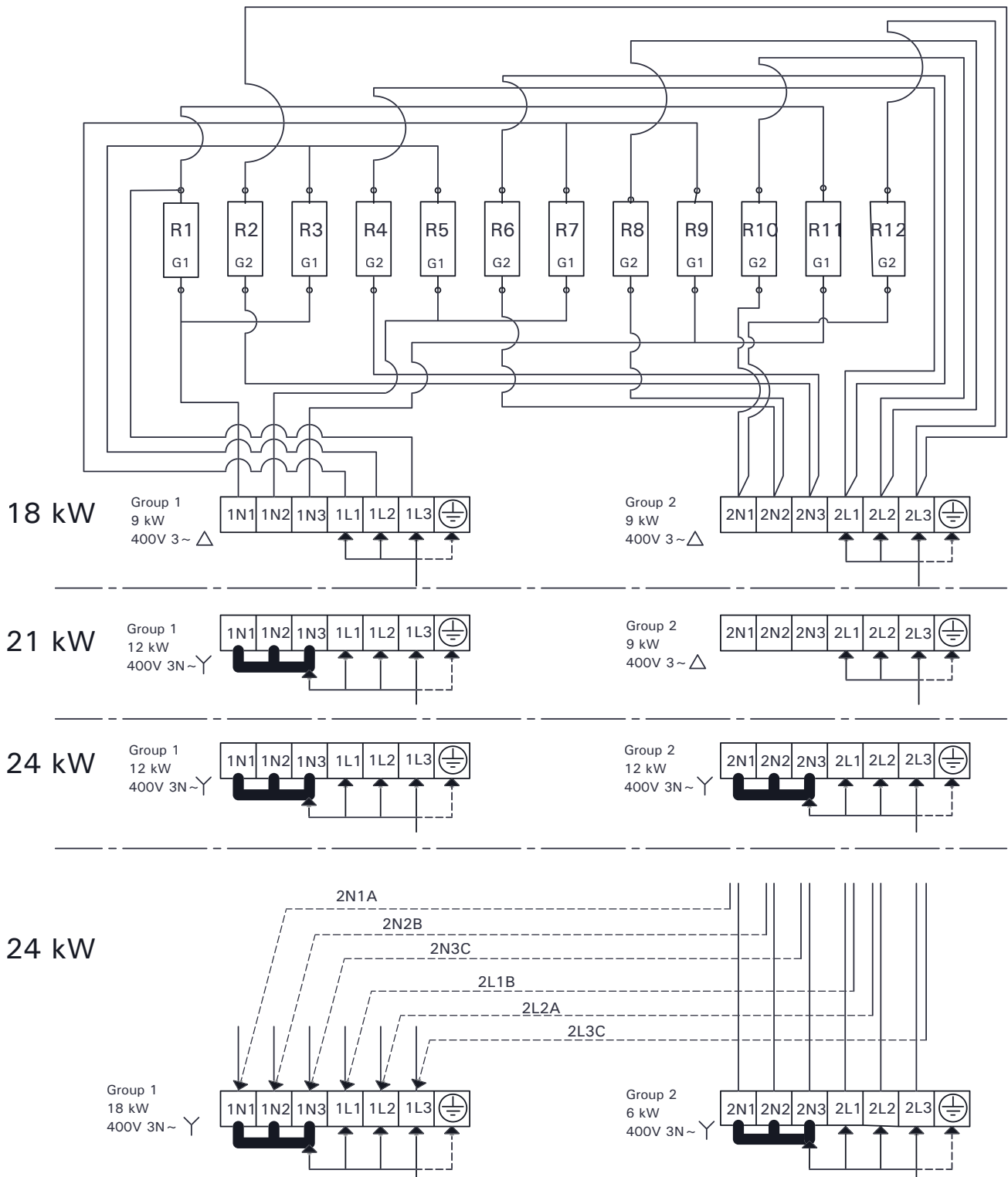

Y05-0394